

Disinfectant Information



P.O. Box 12 | Merton, WI 53056 | 262.538.1122 or 800.551.9679 | www.essind.com

Last updated: March 20, 2020

To Disinfect* Properly:



Clean surface prior to disinfecting.



Dilute disinfectant as directed on label.



Wet all surfaces thoroughly.



Let product dwell on surface for 10 minutes.



Wipe surfaces dry with a clean cloth.

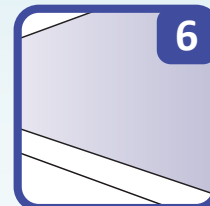

Surfaces are safe to touch when dry.

* Please refer to label for complete directions and PPE recommendations.

Directions for Use and Precautionary Statements for Essential Products:

EPA Reg. Number: 10324-155-3838:

[Neutral Germicidal Cleaner \(702DN\) - Squeeze-N-Pour](#)

[Neutral Germicidal Cleaner \(702DN\) - Gallon](#)

[Neutral Germicidal Cleaner #42 \(2749SC\) - 2-Liter](#)

EPA Reg. Number: 10324-63-3838:

[Quat Rinse \(2331FS\) - 2½ Gallon](#)

[Quat Rinse \(2331FS\) - Gallon](#)

[Quat Rinse \(2331RR\) - 2½ Gallon](#)

EPA Reg. Number: 10324-85-3838:

[Readiquat™ \(733DN\) - Quart](#)

EPA Reg. Number: 10324-93-3838:

[Restroom Cleaner and Disinfectant #50 \(2750SC\) - 2-Liter](#)

[Quat 44 \(2318DN\) - Gallon](#)

Disinfectant FAQ's:

Q: Do your disinfectant products meet the EPA's criteria for use against SARS-CoV-2, the cause of COVID-19?

A: All of Essential's products are on the [EPA's N-List](#). This is a list of products that include the human coronavirus claim. Essential's quat manufacturer is in the process of securing the emerging viral pathogens off label claim.

Q: What does *dwell time* mean?

A: Dwell time is the same as **contact time**; which you will see listed on disinfectant labels. All of our disinfectant products require a dwell/contact time of 10 minutes for disinfecting surfaces.

Q: Should I pre-clean a surface before using a disinfectant?

A: If an area is soiled, it should be cleaned prior to disinfecting. We recommend Blue Concentrate (2085FC).

Q: How long does a disinfectant need to stay on the surface to work effectively?

A: All of Essential's disinfectant products have a contact (dwell) time of 10 minutes for disinfecting surfaces. This means that the surface should remain wet for 10 minutes.

Q: Are surfaces safe to touch after the disinfectant product has been applied?

A: Surfaces are safe to touch **AFTER** the disinfectant product has dried or the surface has been wiped dry after the 10 minute contact time.

Q: Should food contact surfaces (cafeteria tables, desks) be treated differently than non-food contact surfaces?

A: Yes. Food contact surfaces should be rinsed with potable water after the 10 minute contact time and then dried.

For information on location-specific recommendations for cleaning and disinfecting, go to the CDC website:

<https://www.cdc.gov/coronavirus/2019-ncov/community/index.html>